

Location

Location Map

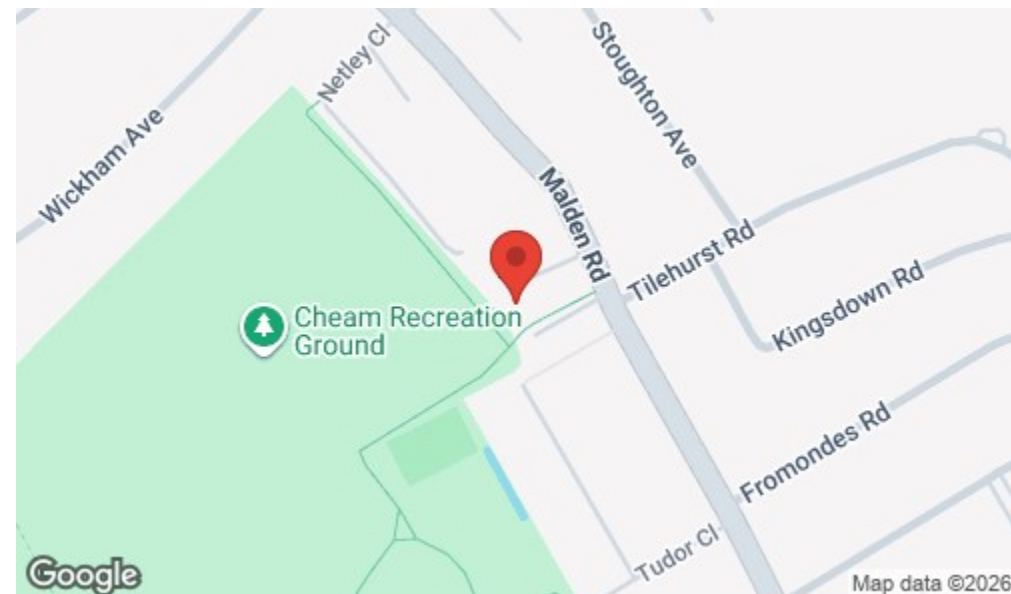

Important Note

Centro Residential Sales and Lettings limited have not tested any services, heating system, electrical system, appliances, fixtures and fittings, that may be included in this property and would advise interested parties to satisfy themselves as to their condition or investigating the presence of any deleterious materials.

Viewing: Strictly by appointment through:

CENTRO RESIDENTIAL SALES AND LETTINGS LIMITED

Tel: 020 8401 5000

E-mail: residential@centro.plc.uk

See a selection of our properties at www.centro.plc.uk

£3,250 Per Month -
Malden Road, Cheam, SM3 8QY



Description

- Detached House
- Backing Cheam Park
- Four Double Bedrooms
- Two Bathrooms
- Cul-De-Sac
- Available Now
- EPC Rating : D
- Council Tax Band : F

Features

- Gas Central Heating
- Double Glazing
- Neutral Decor

What you need to know

- Term: 12 months
- Rent: £3250pcm exclusive of bills
- Security deposit: £3750.00
- Council Tax Band: F
- Energy Rating: D



Accommodation

Additional Photo



All dimensions and measurements are approximate and for guidance only.

Just Centro's Opinion...

Nestled in a cul-de-sac on Malden Road, backing Cheam Park, this impressive detached house offers a perfect blend of comfort and convenience. The property boasts four generously sized double bedrooms, ensuring ample space for family living or hosting guests.

The heart of the home is a welcoming reception room, ideal for relaxation or entertaining. The property also features two well-appointed bathrooms, providing convenience for busy mornings and family life.

One of the standout features of this residence is its delightful backing onto Cheam Park, offering a picturesque view and easy access to green spaces for leisurely strolls or outdoor activities. The location is perfect for families, providing a peaceful environment while still being close to local amenities and transport links.

Additionally, the property benefits from driveway parking, ensuring that you have a secure and convenient space for your vehicles.

This charming home is a rare find in a sought-after area, making it an excellent opportunity for those looking to settle in Cheam. With its spacious layout and prime location, this property is sure to appeal to a variety of tenants seeking a comfortable and stylish living space.

Available to view now.

EPC Graph

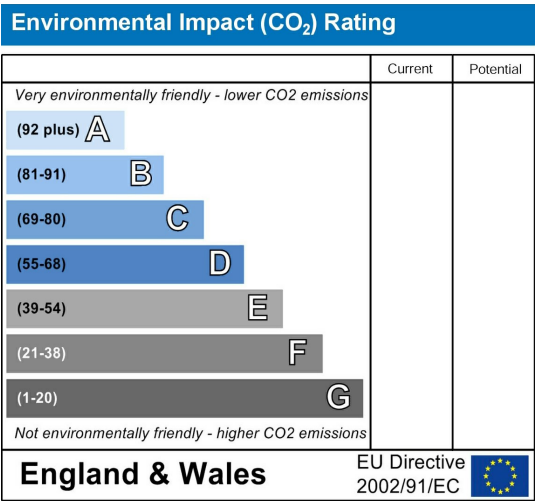
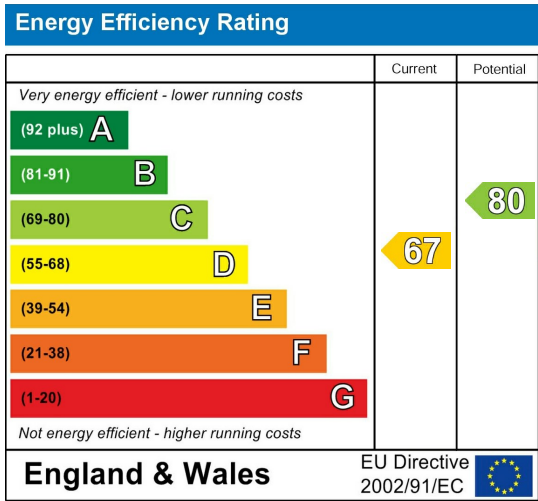

Floor Plan

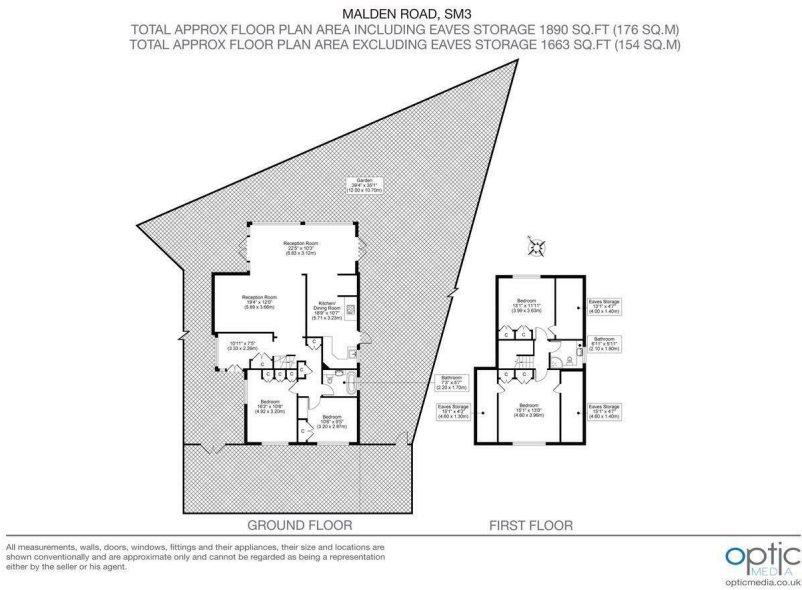

For illustration purposes only